

Nintendo Switch*

1

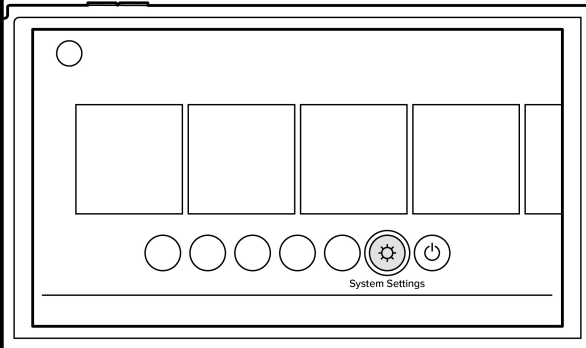

Systemeinstellungen
System Settings
Paramètres de la console

2

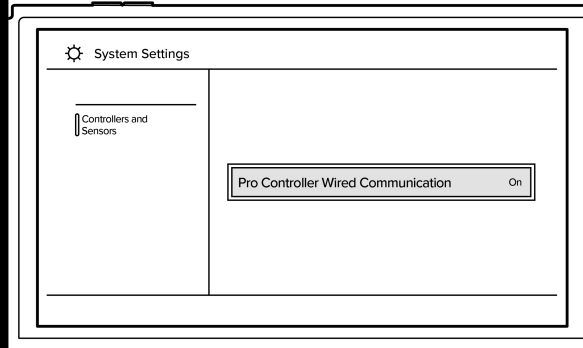

Controller & Sensoren → Kabelverbindung Pro Controller
Controllers & Sensors → Pro Controller Wired Communication
Manettes & capteurs → Connexion par câble des manettes Pro

3

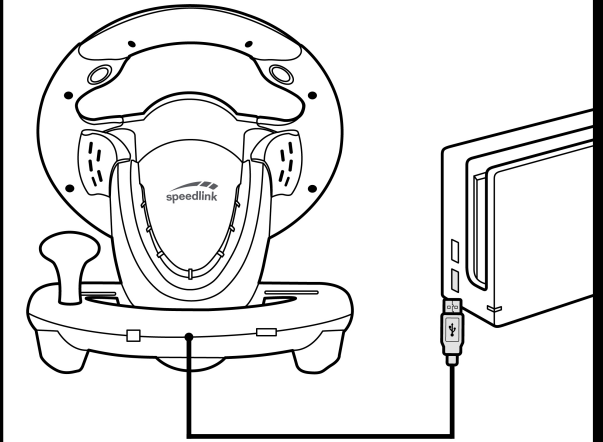

PC

1

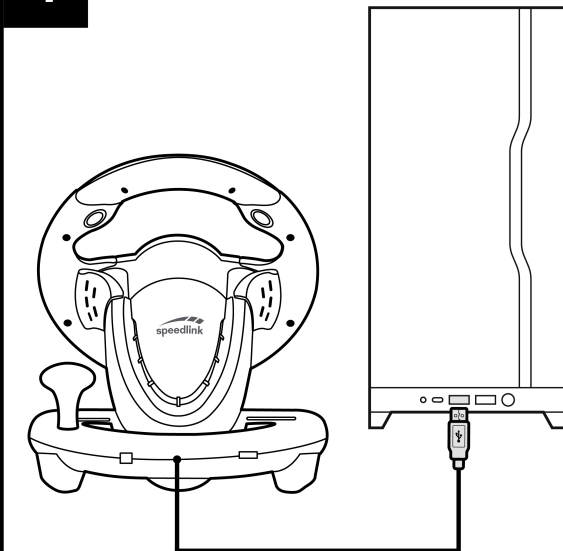

2

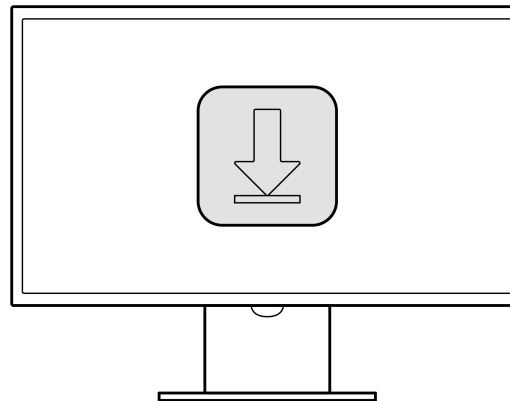

Treiber herunterladen unter www.speedlink.com
Download the driver at www.speedlink.com
Téléchargez le pilote sur www.speedlink.com

3

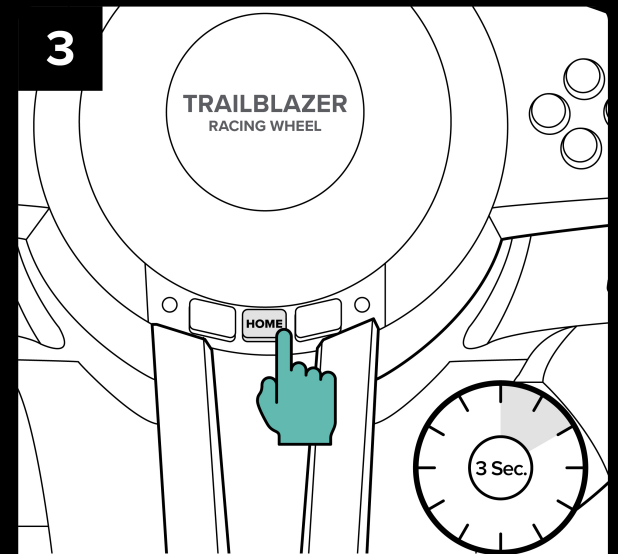

Wechsel XInput/DirectInput* Modus
Switch XInput/DirectInput* mode
Changement du mode XInput/DirectInput*